

HI6501-P SERIES INSTRUMENT

REV.	ECO/DDC	DESCRIPTION	DATE	DRAFT	CHECK	APVD
A	---	RELEASED.	01-23-24	V.J.C.	L.N.	V.J.C.
B	12162	REVISED PER ECN.	06-14-24	V.J.C.	L.N.	V.J.C.

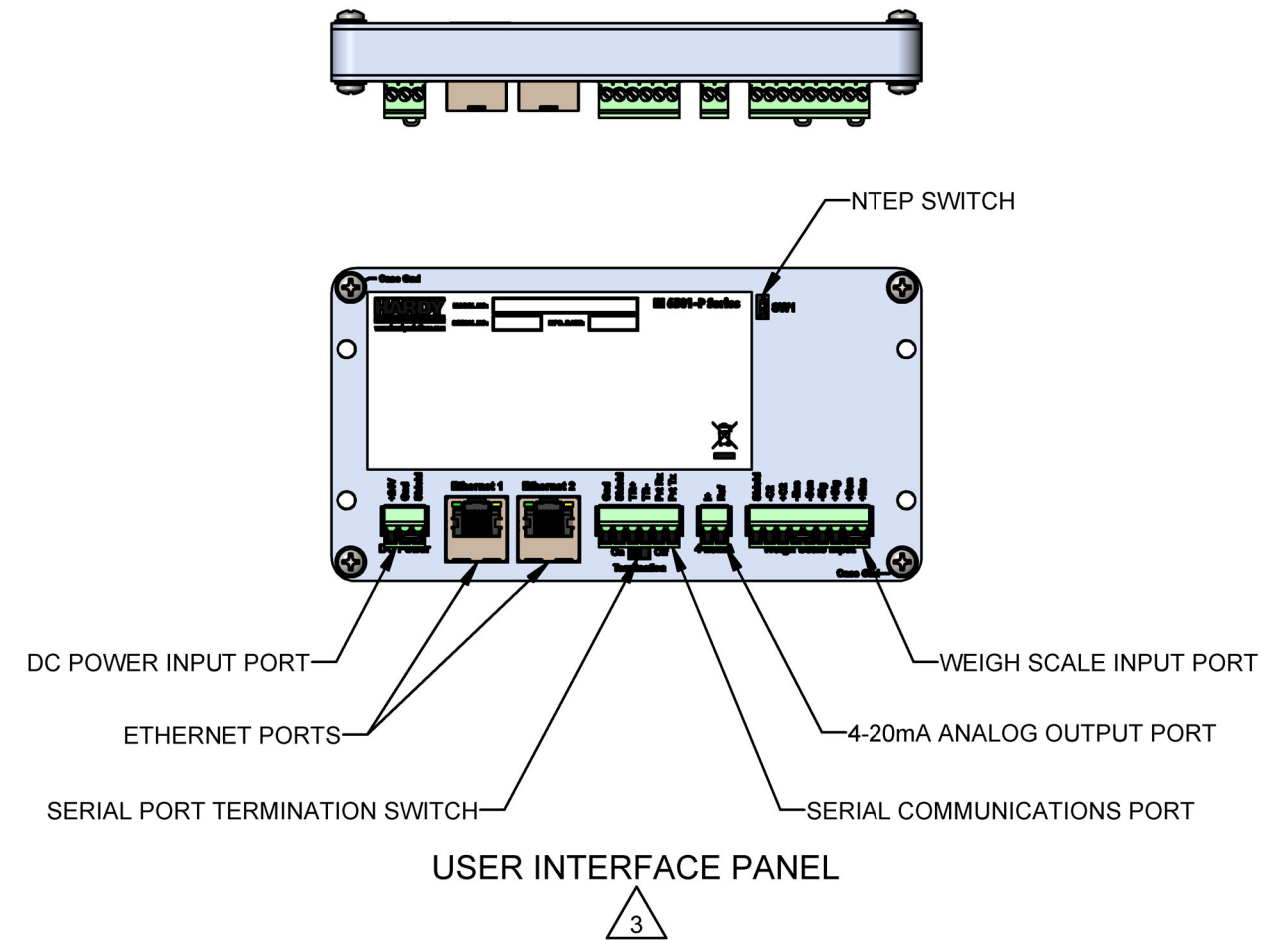
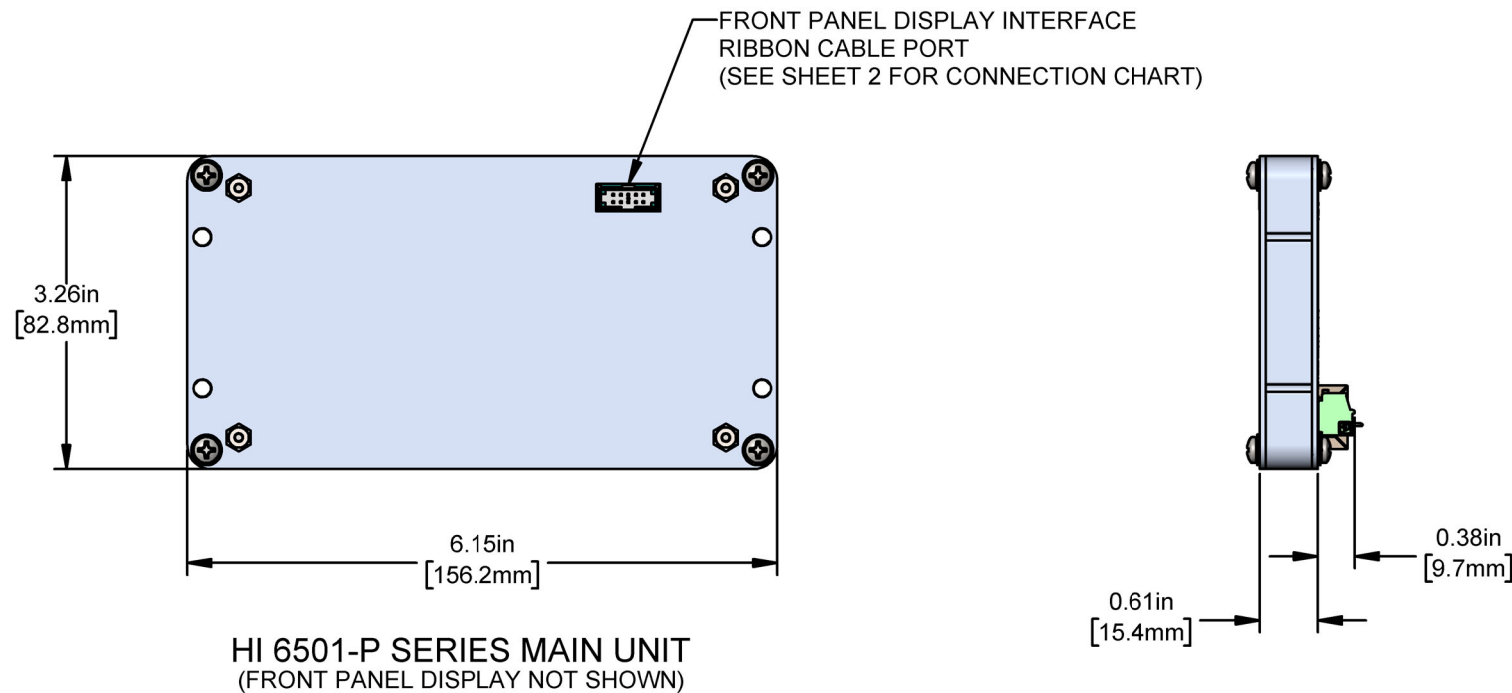
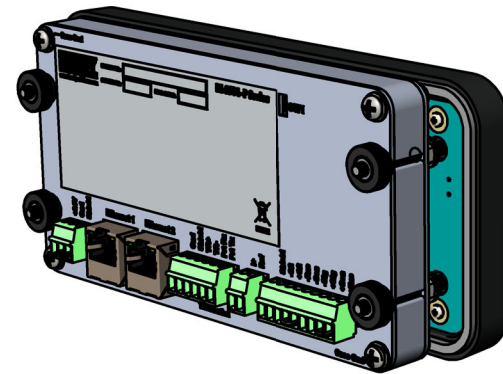

4. IF THE HI6501-P INSTRUMENT IS USED IN A MANNER NOT SPECIFIED BY HARDY PROCESS SOLUTIONS, THE PROTECTION PROVIDED BY THE INSTRUMENT MAY BE IMPAIRED.

3 SEE SHEETS 3 AND 4 FOR USER INTERFACE CONNECTIONS.

2. SEE SHEET 2 FOR FRONT PANEL DISPLAY MOUNTING INFORMATION.

1. SEE HARDY PROCESS SOLUTIONS WEB SITE FOR ADDITIONAL MOUNTING AND WIRING INFORMATION.

NOTES: UNLESS OTHERWISE SPECIFIED

PROPRIETARY NOTICE
ALL DATA AND INFORMATION CONTAINED IN OR DISCLOSED BY THIS DOCUMENT IS CONFIDENTIAL AND PROPRIETARY INFORMATION OF HARDY PROCESS SOLUTIONS AND ALL RIGHTS THEREIN ARE EXPRESSLY RESERVED. BY ACCEPTING THIS MATERIAL THE RECIPIENT AGREES THAT THIS MATERIAL AND THE INFORMATION CONTAINED THEREIN IS HELD IN CONFIDENCE AND IN TRUST AND SHALL NOT BE USED, COPIED, REPRODUCED IN WHOLE OR IN PART, NOR ITS CONTENTS REVEALED IN ANY MANNER TO OTHERS, EXCEPT TO MEET THE SPECIFIC PURPOSE FOR WHICH IT WAS DELIVERED.

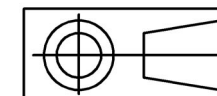

ITEM	QTY	PART NUMBER	DESCRIPTION	COMMENTS
		0584-0116	INSTALLATION/INTERCONNECTION DIAGRAM, HI6501-P SERIES	SEE NOTES
PARTS LIST				
UNLESS OTHERWISE SPECIFIED DIMENSIONS ARE IN INCHES TOLERANCES ARE: FRACTIONS: N/A DECIMALS: .XX = ±.03 .XXX = ±.010 ANGLES ±0°, 30°			CONTRACT NO.	
MATERIAL			APPROVALS	
FINISH			DRAWN V. CHULA	DATE 07-05-23
DO NOT SCALE DRAWING			CHECKED L. NICDAO	DATE 01-23-24
			APPROVED V. CHULA	DATE 01-23-24
			ISSUED V. CHULA	DATE 01-23-24
			PRODUCTION	DATE
		TITLE		REV.
		HARDY PROCESS SOLUTIONS		B
		INSTALLATION/INTERCONNECTION DIAGRAM, HI6501-P SERIES		
SIZE	FSCM	DRAWING NO.		
D	21316	0584-0116		
FILE NAME:0584-0116B1.SLDDRW		SCALE: NONE	SHEET 1 OF 4	

HI6501-P SERIES INSTRUMENT WITH FRONT PANEL DISPLAY

- WHEN ORDERED, THE HI6501-P FRONT PANEL DISPLAY INCLUDES THE FOLLOWING COMPONENTS:
1. MODEL HI 6130 - 4.3 INCH TOUCH SCREEN LCD DISPLAY (SEALING GASKET INCLUDED); QTY 1.
 2. 4.00 INCH [101.6mm] LONG 10 POSITION DISPLAY INTERFACE RIBBON CABLE; QTY 1.
 3. M4 X 0.7, 40mm LONG THREADED RODS, QTY 4.
 4. M4 FLAT WASHERS; QTY 4.
 5. M4 X 0.7 HEX NUTS; QTY 4.
 6. M4 X 0.7 THREADED THUMB NUTS; QTY 4.
 7. DISPLAY MOUNTING HOLE DRILL TEMPLATE; QTY 1.
 8. FRONT PANEL DISPLAY WILL BE SHIPPED SEPARATE WITH INSTRUMENT.
 9. SEE HARDY PROCESS SOLUTIONS WEB SITE FOR FURTHER INFORMATION.

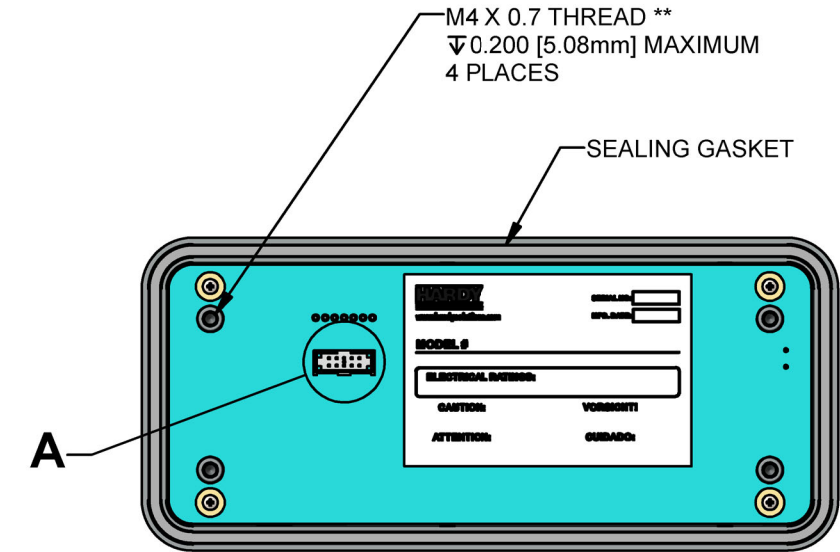
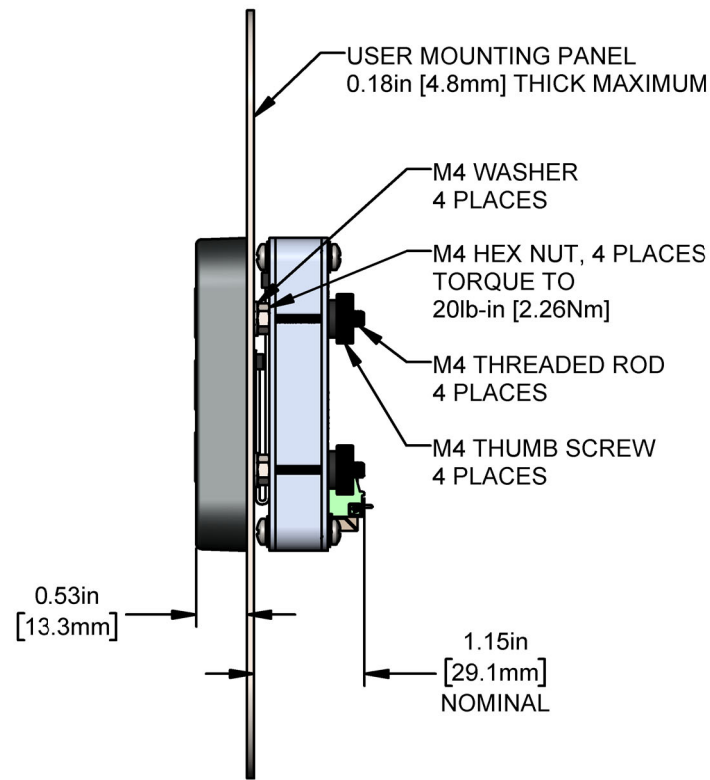
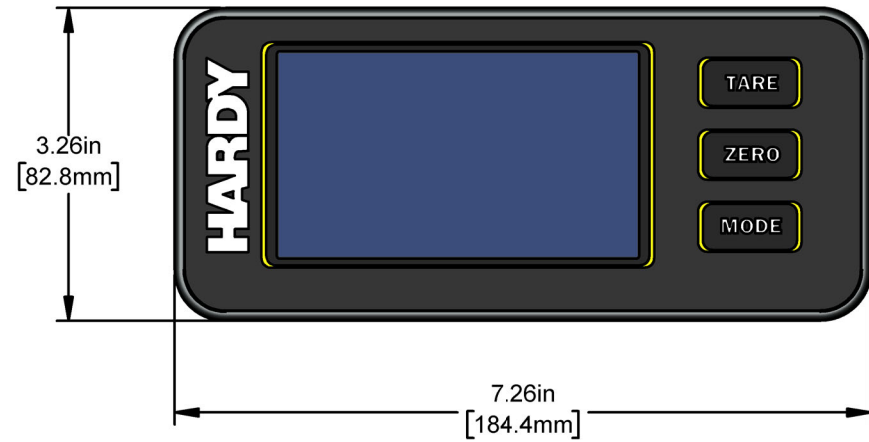

** IF THE DISPLAY IS TO BE MOUNTED REMOTELY FROM THE INSTRUMENT, USE M4 X 0.7 THREADED SCREW LENGTH OF 0.300 INCH [7.62mm] MAXIMUM PLUS THE MOUNTING PANEL THICKNESS

FRONT PANEL DISPLAY TERMINATIONS

NOTES:

1. INPUT VOLTAGE RATING: 12-24 VDC, 1.4 WATTS MAXIMUM.
2. SEE USER'S GUIDE FOR ADDITIONAL INFORMATION ON FRONT PANEL DISPLAY TERMINATIONS. USER'S GUIDE IS LOCATED ON HARDY PROCESS SOLUTIONS WEB SITE.
3. CONNECTOR J9 UTILIZES A 4.00 INCH [101.6mm] LONG 10 POSITION DISPLAY INTERFACE RIBBON CABLE THAT IS SHIPPED WITH THE HI 6850 SERIES INSTRUMENT WHEN OPTION "PM1" IS ORDERED.

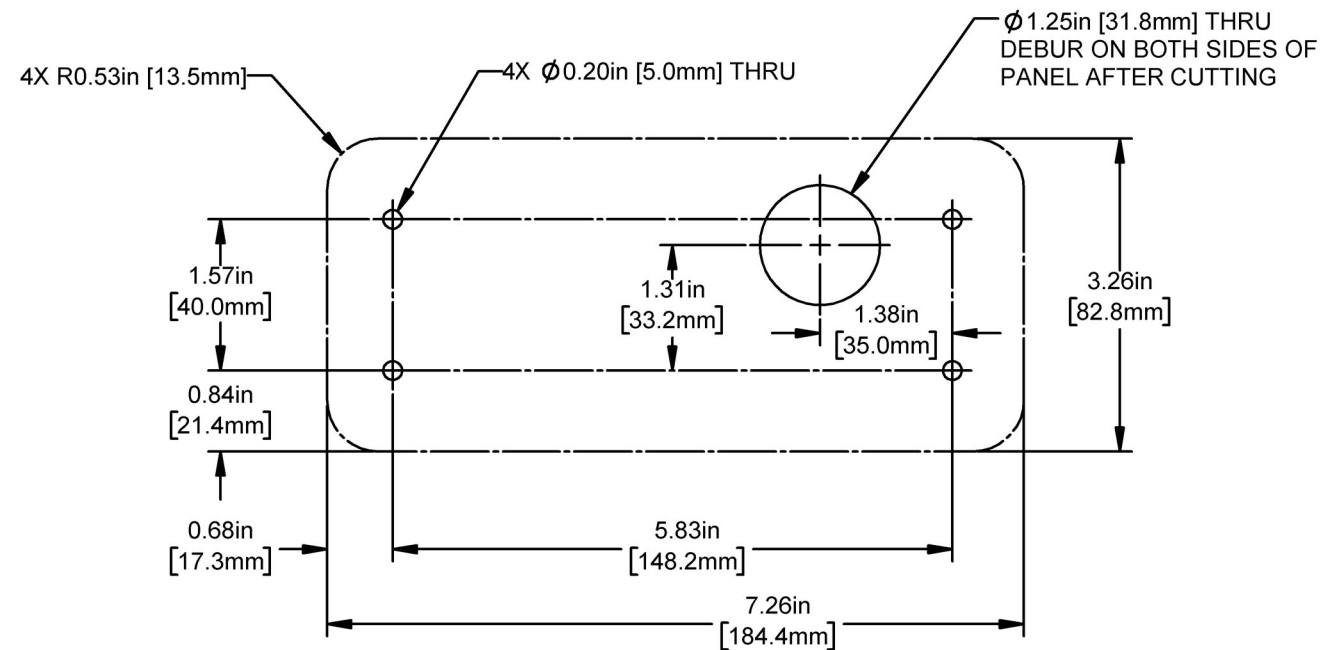

HI 6130 SERIES FRONT PANEL DISPLAY MOUNTING DIMENSIONS
(VIEWED FROM THE FRONT OF THE INSTRUMENT)

J9 CONNECTION CHART	
PIN NUMBER	SIGNAL NAME
1	V+
2	V+
3	CHASSIS GND
4	TXD-
5	TXD+
6	NO CONNECTION
7	RXD+
8	RXD-
9	GND
10	GND
RIBBON CABLE CONNECTOR	

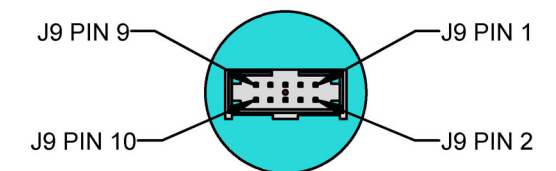

VIEW A
SCALE 2 : 1

HARDY PROCESS SOLUTIONS			
TITLE INSTALLATION/INTERCONNECTION DIAGRAM, HI6501-P SERIES			
SIZE	FSCM	DRAWING NO.	REV.
D	21316	0584-0116	B
FILE NAME: 0584-0116B1.SLDDRW		SCALE: NONE	SHEET 2 OF 4

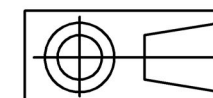

HI6501-P SERIES INSTRUMENT USER INTERFACE PANEL CONNECTIONS

HI6501-P-WP-EIP AND HI6501-P-XP-EIP USER INTERFACE PANEL

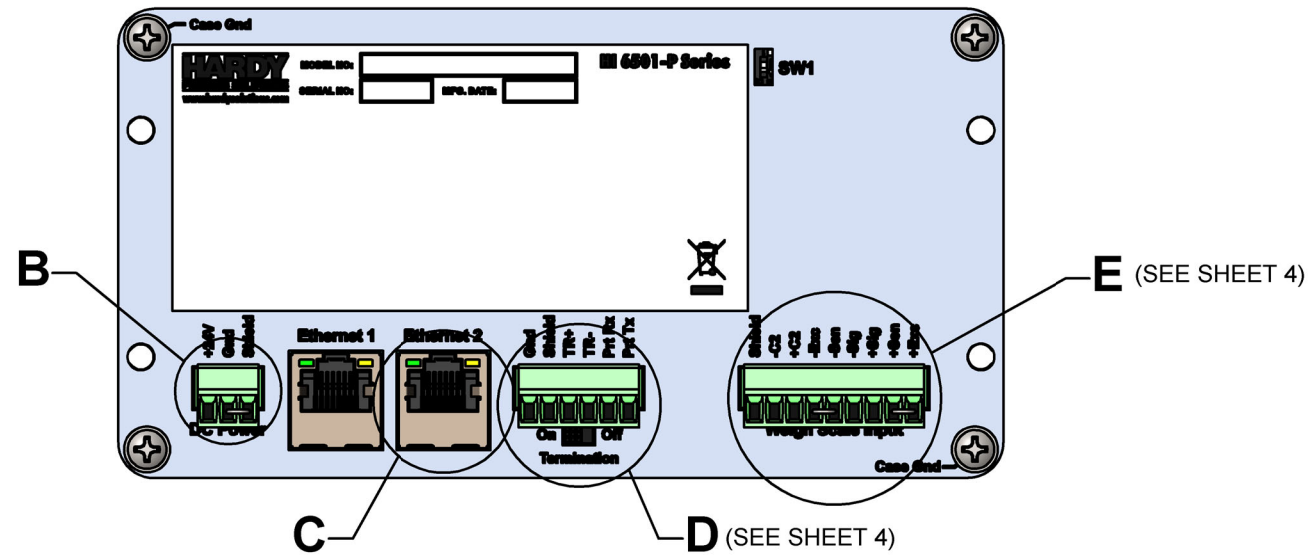

HI6501-P-WP-PFN AND HI6501-P-XP-PFN USER INTERFACE PANEL

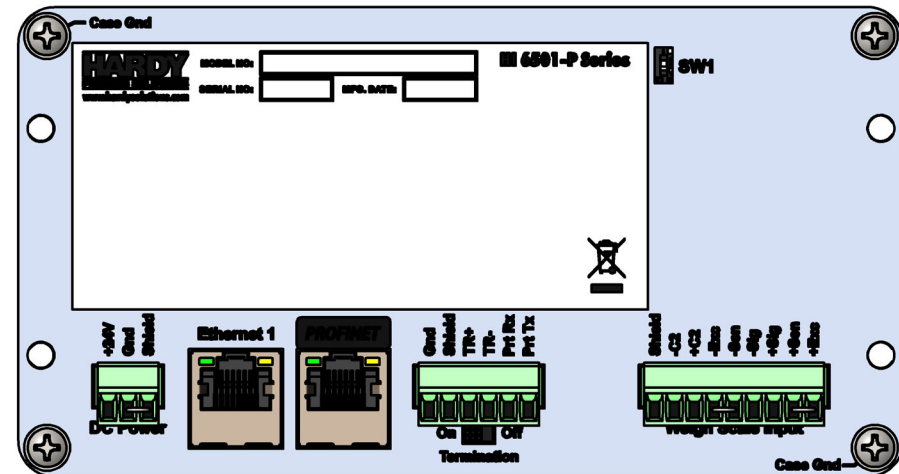

HI6501-P-WP-ANA USER INTERFACE PANEL

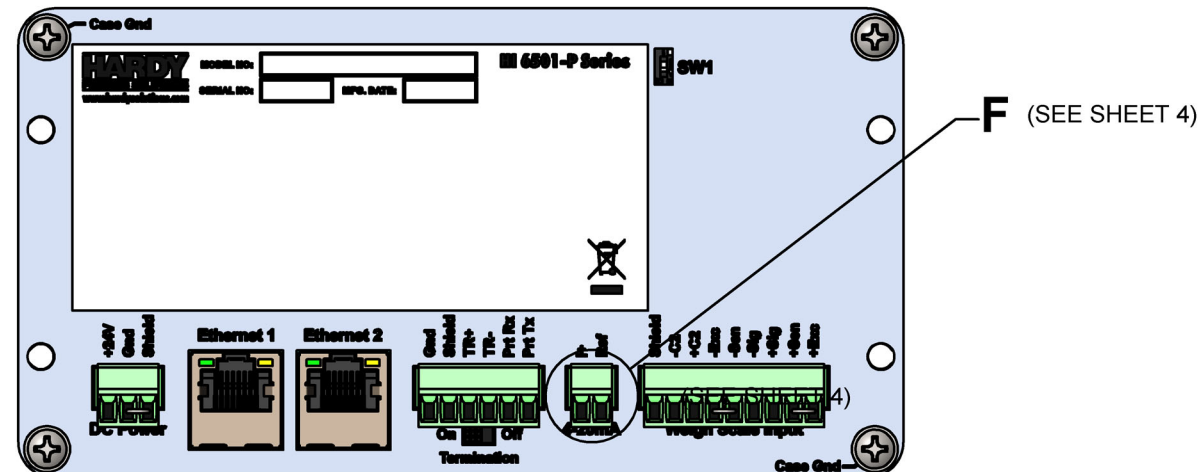

DC POWER INPUT TERMINATIONS

NOTES:

1. CLASS 2 INPUT VOLTAGE RANGE [24VDC NOMINAL]: 12-24 VDC, 3 WATTS NOMINAL.
2. TERMINAL BLOCK WIRE SIZE RANGE: 16 AWG MAXIMUM / 28 AWG MINIMUM.
3. WIRE TEMPERATURE RATING TO BE 90° C.
4. WIRE TIGHTENING TORQUE: 2.0 LB-IN / 2.2 LB-IN [0.23 Nm / 0.25 Nm].
5. USE COPPER CONDUCTORS ONLY.

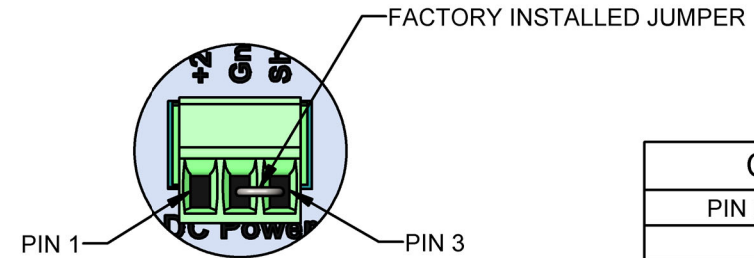

VIEW B

SCALE 3 : 1

CONNECTION CHART

PIN NUMBER	SIGNAL NAME
1	+24V IN
2	GND
3	SHIELD

ETHERNET AND PROFINET TERMINATIONS

NOTES:

1. SEE USER'S GUIDE FOR ADDITIONAL INFORMATION ON ETHERNET AND PROFINET TERMINATIONS. USER'S GUIDE IS LOCATED ON HARDY PROCESS SOLUTIONS WEB SITE.
2. CONNECTOR TYPE: RJ-45, 8 PIN; QTY 2.
3. WHEN "EIP" AND "ANA" UNITS ARE ORDERED, BOTH PORTS CAN BE USED FOR ETHERNET CONNECTIONS;
4. WHEN "PFN" (PROFINET) UNITS ARE ORDERED, THE "ETHERNET 1" PORT IS TO BE USED FOR ETHERNET TCP/IP CONNECTIONS ONLY AND THE "PROFINET" PORT IS TO BE USED FOR PROFINET SPECIFIC CONNECTIONS ONLY.

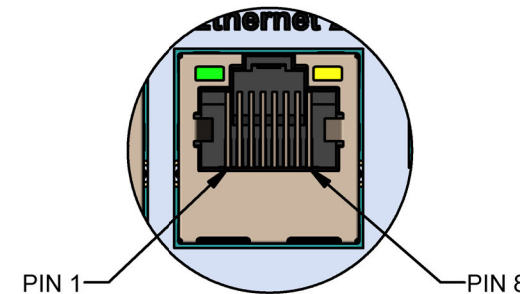

VIEW C

SCALE 3 : 1

CONNECTION CHART

PIN NUMBER	SIGNAL NAME
1	TX+
2	TX-
3	V+
4	GND
5	GND
6	V+
7	RX+
8	RX-



TITLE
INSTALLATION/INTERCONNECTION
DIAGRAM, HI6501-P SERIES

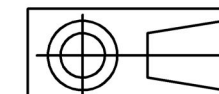

SIZE	FSCM	DRAWING NO.	REV.
D	21316	0584-0116	B

FILE NAME: 0584-0116B1.SLDDRW SCALE: NONE SHEET 3 OF 4

HI6501-P SERIES INSTRUMENT USER INTERFACE PANEL CONNECTIONS

SERIAL COMMUNICATIONS PORT TERMINATIONS

NOTES:

1. SEE USER'S GUIDE FOR ADDITIONAL INFORMATION ON SERIAL COMMUNICATIONS TERMINATIONS. USER'S GUIDE IS LOCATED ON HARDY PROCESS SOLUTIONS WEB SITE.
2. DO NOT BUNDLE SERIAL COMMUNICATION WIRING WITH POWER WIRING, RELAY CABLE OR ANY OTHER HIGH ENERGY CABLES.
3. TERMINAL BLOCK WIRE SIZE RANGE: 16 AWG MAXIMUM / 28 AWG MINIMUM.
4. WIRE TEMPERATURE RATING TO BE 90° C.
5. WIRE TIGHTENING TORQUE: 2.0 LB-IN / 2.2 LB-IN [0.23 Nm / 0.25 Nm].
6. USE COPPER CONDUCTORS ONLY.

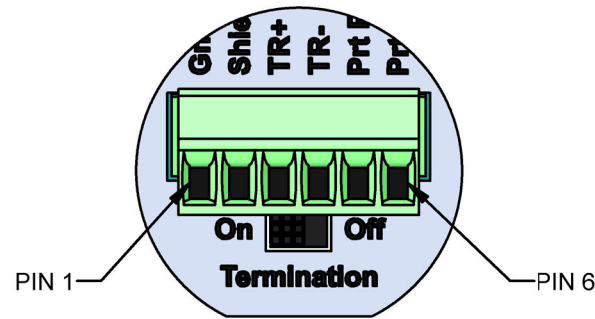

VIEW D
SCALE 3 : 1

CONNECTION CHART	
PIN NUMBER	SIGNAL NAME
1	GND
2	SHIELD
3	TR+
4	TR-
5	PRT RX
6	PRT TX

4-20mA ANALOG OUTPUT PORT TERMINATIONS

NOTES:

1. SEE USER'S GUIDE FOR ADDITIONAL INFORMATION ON ANALOG OUTPUT TERMINATIONS. USER'S GUIDE IS LOCATED ON HARDY PROCESS SOLUTIONS WEB SITE.
2. DO NOT BUNDLE ANALOG OUTPUT WIRING WITH POWER WIRING, RELAY CABLE OR ANY OTHER HIGH ENERGY CABLES.
3. TERMINAL BLOCK WIRE SIZE RANGE: 16 AWG MAXIMUM / 28 AWG MINIMUM.
4. WIRE TEMPERATURE RATING TO BE 90° C.
5. WIRE TIGHTENING TORQUE: 2.0 LB-IN / 2.2 LB-IN [0.23 Nm / 0.25 Nm].
6. USE COPPER CONDUCTORS ONLY.

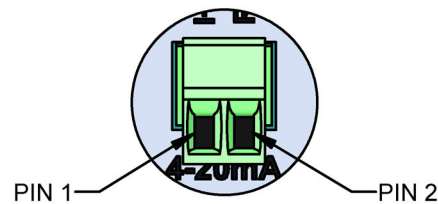

VIEW F
SCALE 3 : 1

CONNECTION CHART	
PIN NUMBER	SIGNAL NAME
1	I+
2	REF

WEIGH SCALE INPUT TERMINATIONS

NOTES:

1. SEE USER'S GUIDE FOR ADDITIONAL INFORMATION ON LOAD CELL CONNECTIONS. USER'S GUIDE IS LOCATED ON HARDY PROCESS SOLUTIONS WEB SITE.
2. IF CONDUIT IS USED, DO NOT RUN LOAD CELL CABLE PARALLEL TO, OR IN SAME CONDUIT WITH, POWER WIRING, RELAY CABLE OR OTHER HIGH ENERGY CABLES.
3. FACTORY INSTALLED JUMPERS TO REMAIN IN PLACE ONLY FOR FOUR WIRE NON C2 LOAD CELL CONNECTION. JUMPERS TO BE REMOVED FOR SIX WIRE NON C2 OR EIGHT WIRE C2 LOAD CELL CONNECTIONS. EXCITATION AND SENSE WIRES TO BE CONNECTED TOGETHER IN JUNCTION BOX.
4. TERMINAL BLOCK WIRE SIZE RANGE: 16 AWG MAXIMUM / 28 AWG MINIMUM.
5. WIRE TEMPERATURE RATING TO BE 90° C.
6. WIRE TIGHTENING TORQUE: 2.0 LB-IN / 2.2 LB-IN [0.23 Nm / 0.25 Nm].
7. USE COPPER CONDUCTORS ONLY.

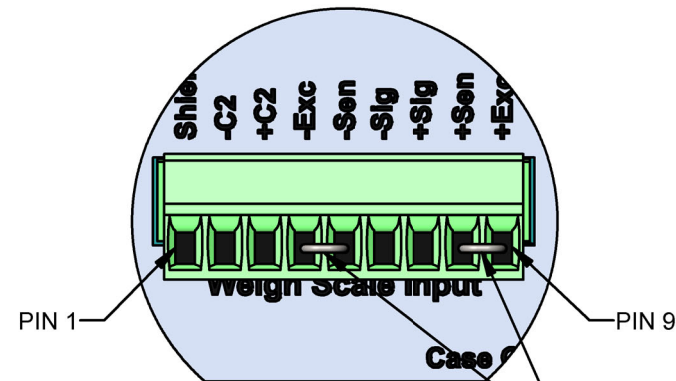

VIEW E
SCALE 3 : 1

FACTORY INSTALLED JUMPERS (TO BE REMOVED WHEN LOAD SENSORS WITH SIX WIRES ARE USED)

CONNECTION CHART	
PIN NUMBER	SIGNAL NAME
1	SHIELD
2	-C2
3	+C2
4	-EXC
5	-SEN
6	-SIG
7	+SIG
8	+SEN
9	+EXC

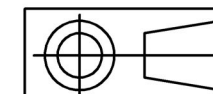

HARDY PROCESS SOLUTIONS			
TITLE INSTALLATION/INTERCONNECTION DIAGRAM, HI6501-P SERIES			
SIZE D	FSCM 21316	DRAWING NO. 0584-0116	REV. B
FILE NAME: 0584-0116B1.SLDDRW		SCALE: NONE	SHEET 4 OF 4